

# 6 Pack Multimode ST Simplex Fiber Adapter Panel

Part Numbers:  
FE-B0506  
FE-6ST (Made in USA)



## Dimensions

Depth	30.48 mm   1.20 in
Height	30.48 mm   1.20 in
Width	130.2 mm   5.125 in

## General Specification

Product Type	Panel
Interface	ST
Body Style	Simplex
Adapters, Cutout Quantity	6
Adapters, Quantity	6
Mount Type	Rack Mount
Color	Satin Black

## Specification

Product Standard Certification	UL
RoHS 2002/95/EC	Compliant
ISO 9001:2008	

## Construction Materials

Material Type	Steel
Material	16AWG Steel (Corrosion-Resistant)
Coating	Electrostatic Polyester Powder Coat Rust-Resistant Finish
Adapters	Phosphor-Bronze Alignment Sleeves Zirconia Ceramic Alignment Sleeves

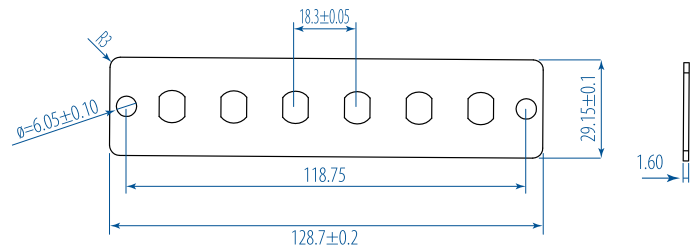
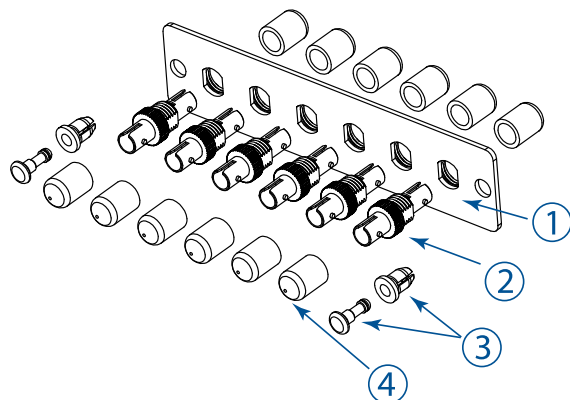

\* All measurements in mm

1	Black Galvannealed Steel Adapter Panel. 6 - SIMPLEX ST
2	Ceramic Sleeve SIMPLEX ST Adapter
3	Plastic Push Pin
4	Dust Caps